

# VALVE, VALVE SPRING, VALVE SEAL, VALVE GUIDE CONSTRUCTION [ZJ, Z6]

B3E011012111T03

- The valves are made of heat-resistant steel for wear resistance improvement.

## Valve specification

| Item                            |              | ZJ  | Z6  |
|---------------------------------|--------------|---|---|
| Valve full length               | (mm<br>{in}) | Intake valve: Approx. 98.3 {3.87}<br>Exhaust valve: Approx. 98.7 {3.89} | Intake valve: Approx. 97.1 {3.82}<br>Exhaust valve: Approx. 96.6 {3.81} |
| Intake valve umbrella diameter  | (mm<br>{in}) | Approx. 27.7 {1.09}   | Approx. 29.2 {1.15}   |
| Exhaust valve umbrella diameter | (mm<br>{in}) | Approx. 24.0 {0.94}   | Approx. 25.9 {1.02}   |
| Stem diameter                   | (mm<br>{in}) | Intake valve: Approx. 5.5 {0.22}<br>Exhaust valve: Approx. 5.5 {0.22}   |   |

- The intake valve and the exhaust valve are tufftride processed to improve abrasion resistance.
- The valve spring with an uneven outer dimension has been adopted. By reducing the size of the upper seat, valve spring load has been reduced, and fuel consumption has been improved.
- The valve guide is made of sintered alloy to improve abrasion resistance.
- The valve seat is integrated with the lower valve spring seat to simplify the unit and improve its serviceability.

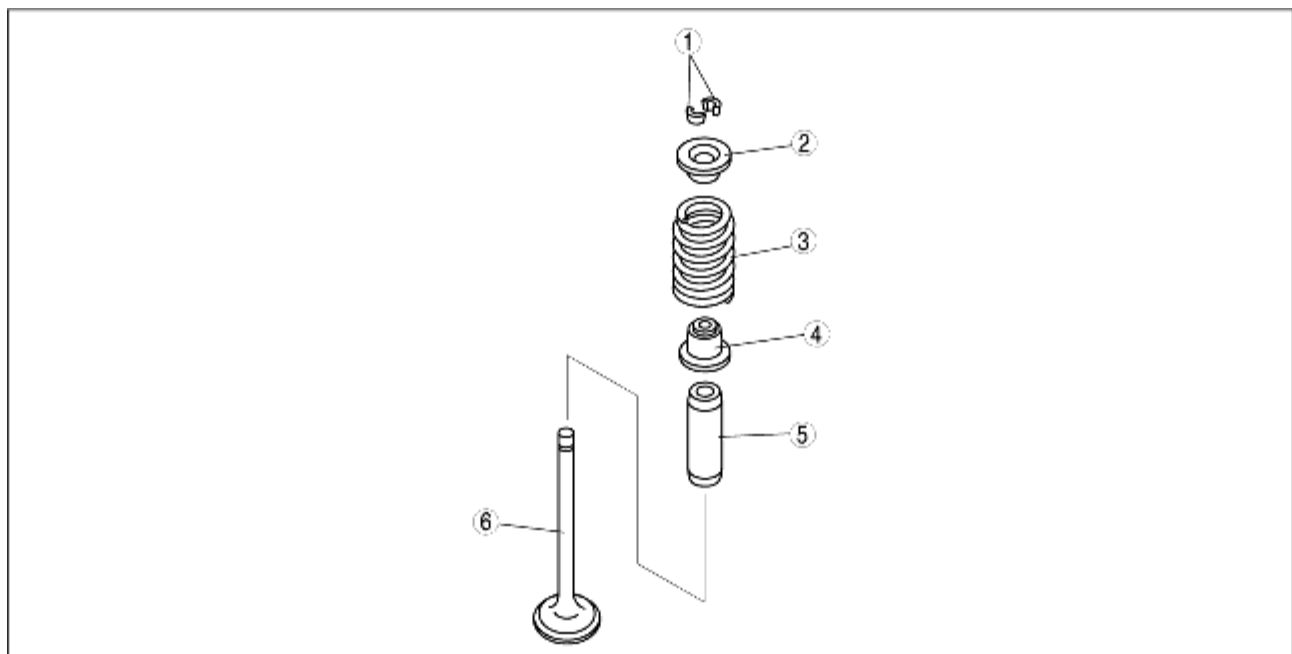

B3E01 10T019

|   |                         |
|---|-------------------------|
| 1 | Valve keeper            |
| 2 | Upper valve spring seat |
| 3 | Valve spring            |
| 4 | Valve seal              |
| 5 | Valve guide             |
| 6 | Valve                   |